



Dull Olson Weekes - IBI Group Architects, Inc.
 907 SW Stark Street
 Portland OR 97205 USA
 tel 503 226 6950
 fax 503 273 9192



Meeting Notes

From Karina Ruiz **Date** August 2, 2013
Project Franklin HS Modernization **Project No.** 13-023
Subject Design Advisory Group (DAG) #2
 Franklin HS Library
 July 25, 2013 5:30 – 7:30PM

INVITEES

(Attendees in Bold)

Project Team

Debbie Pearson, PPS OSM
 CJ Sylvester, PPS OSM
Jim Owens, PPS OSM
Rolando Aquilizan, PPS OSM
Karina Ruiz, DOWA-IBI Group
 Steve Olson, DOWA-IBI Group
 Marc Nordean, DOWA-IBI Group
 Shay James, FHS Principal
 Marshall Haskins, FHS Vice Principal
 Ivonne Diblee, FHS Vice Principal
Steve Mathews, FHS Business Manager
2 Members of the Public

Design Advisory Group (DAG)

Greg Belisle, School Board Representative
Leigh Brown, SPED Representative
Maria Carlsen, Student Representative
 Joyce Gago, Community Representative
Jeff Hammond, Neighbor & Local Business Rep
Roger Kirchner, Parent Representative
 Pam Knuth, FHS Alumni President
Heidi Leineweber, Teacher Representative
Amber McGill, SUN School Representative
Dana Vinger, Teacher Representative
 Lisa Zuniga, Parent Representative

SUMMARY

The following is a brief summary of the discussions that took place at this meeting. Action items will be specifically noted.

- I. Introductions
 - The group introduced themselves and Debbie introduced the firm that has been selected for the Franklin HS Modernization projects, DOWA-IBI Group.
- II. Current Topic Review – Site Planning
 - The bleachers in the bowl are in really bad shape and need to be addressed.
 - i. Accessibility issues exist throughout the site, but there is a strong desire to bring wheelchair accessibility to the lower level of the grandstands.
 - There are numerous accessibility issues associated with neighborhood access to the site
 - i. The corner of 52nd and Woodward is not safe. There have been serious car accidents on this corner in the past.
 - ii. This access point is used by a lot of students going to the market during lunch or heading to and from the public bus stop.
 - iii. There needs to be clarity at the exit and entrance to the site at this SW corner.



- The group indicated they would like to see a separation between parent pick-up and drop-off and the pick-up and drop-off for special ed busses. Although, there are no large school busses in service at Franklin, there is significant backup during arrival and dismissal due to this conflict.
 - i. There needs to be careful consideration given to parking and overall site circulation.
- Special attention should be paid to the security and impact of the site on the adjacent Atkinson ES site. How do we link these sites but still create individual identities and mitigate security concerns?
- Site lighting is an issue throughout the site as there are significant dark spots throughout the site.
 - i. There was a desire expressed to light the building elements to highlight their historic significance to the community.
- Debbie reminded the group that FHS was originally designed to face SE Division and asked if there was a desire to relocate the main entrance to the Woodward side by relocating Benji to the Woodward side. The group unanimously agreed that Benji needed to remain where he is and be honored in that location.
 - i. The Benji statue on the interior also needs to be honored and remain in place the kids can interact with it. It was suggested he be located in an atrium space with higher ceilings.
- There are a number of storm water ponding issues on site. See attached site plan mark up.
- Wayfinding onsite and in the building need to be a priority.
 - i. The circulation paths onsite need to be clear.
 - ii. Community access during off hours needs to be welcoming and various partner elements should have their own identity, but remain tied into an overall signage plan.
 - iii. There needs to be a balance between openness to the community and campus security.
- The group indicated that there should be a clear entrance to the school along the east of the football field.
- Outdoor basketball courts would be welcome.
- The current location of the woodshop works well for access for dropoff of materials.
- The group talked about a learning garden and tying it to curriculum. This wouldn't be just for the Foods program, but also STEM and arts focused. It should also be tied to life skills and the childcare program.
- The health clinic and child care programs are important to the community and should definitely be included in the plans.
- There was also a desire expressed for an outdoor classroom or gathering space.
- The north lawn between the main field and the football field should be considered as a quad. The design team needs to think about this area creatively.
 - i. Potentially excavate and place a daylit cafeteria/commons on the same level as the lower lawn.
- The graduation ceremonies held in the bowl are sacred and a rite of passage for the students.
- The group expressed a desire to cover the grandstands but doesn't want to compromise the views to and from the building.
 - i. This cover should be transparent, similar to the cover at Directors Park.
- Debbie indicated that PPS is currently talking with Portland Parks & Rec about partnership opportunities with the adjacent Clinton Park.
- The group would also like to continue to explore partnerships with community colleges.
- There is art in the building that should be salvaged and honored.
 - i. There is a need to create an inventory of memorabilia in the dungeon. Debbie to work with Joyce Gago to identify what is currently down in storage.
- The students love the clerestory windows throughout the school, but acknowledged that all windows perform horribly.

III. Future Topic Review

- The group reviewed the attached topic list and was asked to send additional topics to Debbie for discussion in future meetings.

IV. DAG Meetings

- Debbie reminded the group that our next DAG meeting is scheduled for Monday, August 5th. She will send out meeting requests to the group for future meetings.
- There are two community design charrettes scheduled: Saturday, September 21st and Saturday, October 12th.
- PPS is working to schedule the tour to schools in Seattle for a date that works for the majority of the DAG members for both Franklin and Roosevelt. There is Doodle survey that has been sent out for people to respond to.
 - i. The group pointed out that it would be good to have a weekday and Saturday to choose from.
- The group was worried that this tour was too far out and it was suggested they go and visit Sandy HS. Debbie will consider this request. In the interim, Karina indicated they could provide a “virtual tour” to get folks to consider examples of historic reuse and 21st century learning spaces from around the world. Karina will be prepared to provide this at the next meeting.

V. Rumor Control

- Debbie asked the group to keep her in the loop on discussions happening in the community.
- The DAG will be the main advocacy group for the project in the community.
- The group asked Debbie to provide a sheet of talking points so that they can all work from the same information. Jim indicated that something had recently been prepared for Franklin and Debbie will share that with the DAG.
- There should also be information provided regarding the improvements planned for Marshall in advance of the relocation of the Franklin kids in 2015.
 - i. The students want to know what will impact them in regards to amenities and schedule for move.
 - ii. It was suggested that a tour of Marshall be set up for the Franklin community.
 - iii. There should be careful consideration given to the Marshall community as there are still hard feelings in the community regarding closing of that school.
 - iv. The group felt that the temporary campus should be named, “Franklin HS at the Marshall Campus”.

These meeting notes are a record. If there are any errors and/or omissions in the foregoing notes, please advise our office immediately; otherwise these notes will be considered correct and complete as written.

Submitted by,
Dull Olson Weekes – IBI Group Architects Inc.

Karina Ruiz, AIA | LEED BD+C
Associate Principal

Attachments:

<u>Item:</u>	<u>Pages:</u>	<u>Date:</u>
DAG #2 Agenda	1	7/25/13
Siteplan Markup	1	7/25/13
DAG Topics List	2	7/25/13
Sign-in Sheet	1	7/25/13



Franklin Design Advisory Committee (DAG)

MEETING #2 AGENDA

FACILITATOR:	Debbie Pearson - PPS	MEETING #:	2
MEETING DATE:	July 25, 2013	LOCATION:	Franklin HS – Library/Media Room
RECORD TAKEN BY:	Rolando Aquilizan - PPS	DURATION:	5:30 - 7:30 PM

AGENDA

- | | |
|----------------|--|
| 5:30 PM | Introductions (DAG Roster) <ul style="list-style-type: none">• Name• Affiliation |
| 5:45 PM | Current Topic Review <ul style="list-style-type: none">• Site Planning Issues (Physical, School Site Evaluation, School Building Evaluation) |
| 6:45 PM | Future Topic Review <ul style="list-style-type: none">• Review future topics and modify as required |
| 7:00 PM | DAG Schedule (Stakeholder Engagement Schedule) <ul style="list-style-type: none">• Future Meeting info (day, time, location)• Future Charette dates (1x ea. In Sept/Oct.)• Bus Tour |
| 7:15 PM | Rumor Control |
| 7:20 PM | Public Comments |
| 7:25 PM | Next Steps |

NOTES

- Content from this meeting will be repeated and reviewed again at Meeting #2 for the benefit of members not attendance.
- Meeting record will be posted on the Franklin High School bond website at: <http://www.pps.k12.or.us/bond/8495.htm>

Franklin High School

5405 SE Woodward St, Portland OR, 97206

[View Site in Google Maps](#)

Building Periods

1. Original Building (215A), 1915
2. Boiler Building (215D), 1915
3. Gymnasium Building (215B), 1916
(remodeled to classrooms in 1986)
4. Auditorium Addition (215C), 1924
5. Field House, 1950
6. Classroom Wing (215D), 1950
7. Connecting Addition (215C), 1954
8. Gymnasium (215E), 1954
9. Shop Building (215F), 1970



1910s architectural rendering of Franklin High School, designed by Floyd A. Naramore.



1915 photograph during construction of Franklin High School, looking north.

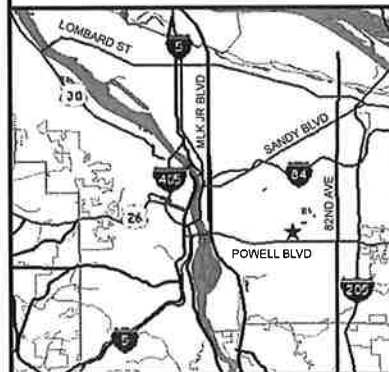

Historical Significance and Building Integrity

- Contributing High Significance
- Contributing Moderate Signif.
- Non-Contributing

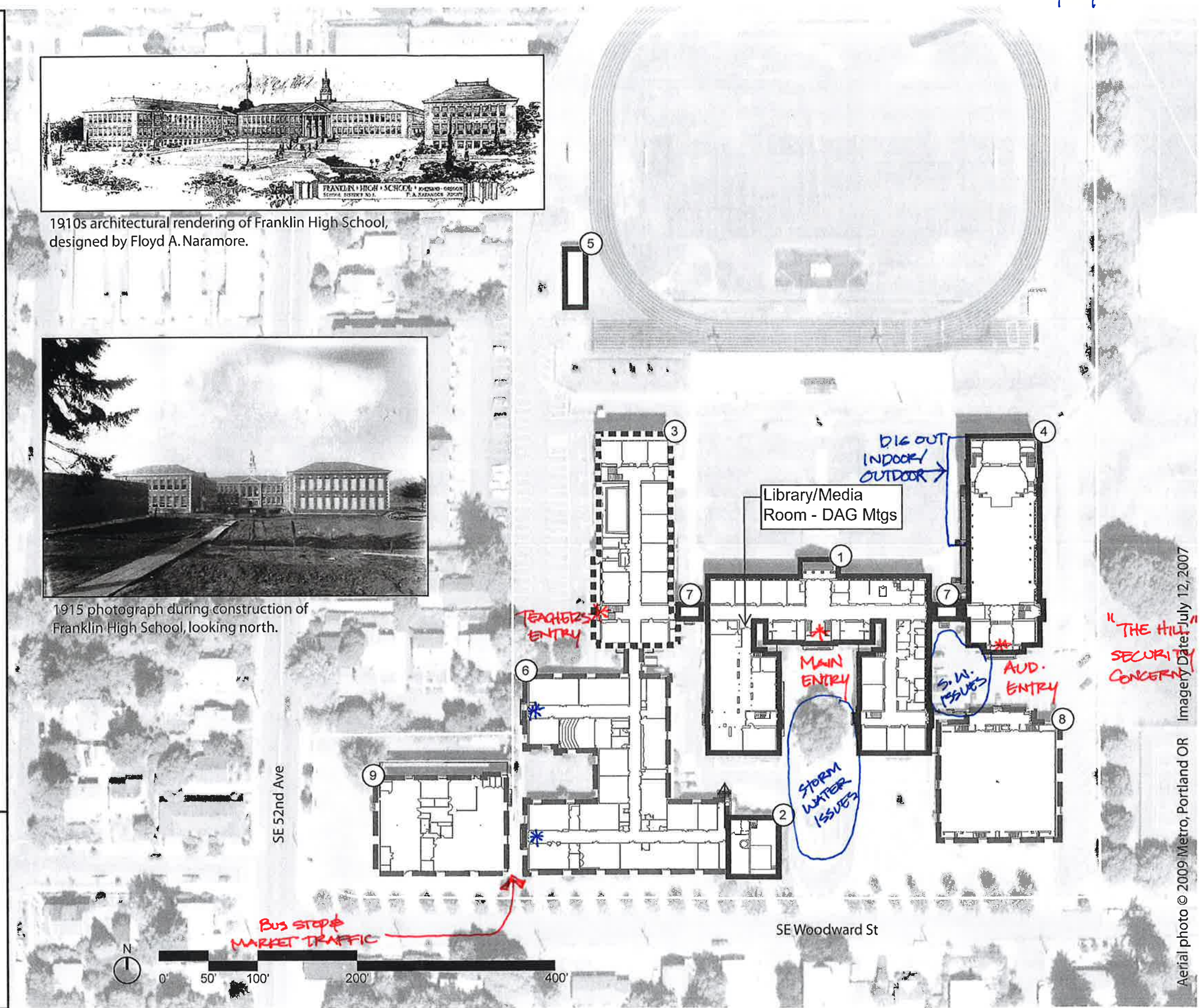

Franklin HS Design Advisory Group

Comprehensive High School – 1500 Students/1500 Core Capacity

Proposed Meeting Topics:

SITE PLANNING

Physical

- Access to School from Bus Stops
- Access to School from neighborhood *1.5 miles walking*
- Security – Lighting, Fencing, Access
- Sports Facilities – needs assessment (turf, 8th lane, etc.) *Turf, 8th lane, Field house /concessions*
- Evening Sports – Community needs, issues?
- Sound Issues
- Other

School Site Evaluation

- Desirable Features
- Undesirable Detractors
- Additional needs to support curriculum or Focus Area (i.e. gardens for food service?)
- Other

School Building(s) Evaluation - Exterior

- Desirable Features
- Undesirable Detractors
- Other

CURRICULUM

Educational

- Existing Program Priorities beyond Core Curriculum (Focus Area – i.e. Woods/Metals, Food Service)
- Current functional distractions
- New Programs planned/proposed
- Partnerships w/other PPS Schools and/or Higher Ed (i.e. PCC Woods/Metals) Warner Pacific University?
- Other

Extra-curricular

- Existing Programs to remain
- Current functional distractions
- New Programs planned/proposed
- Other

Community

- Non-School programs using School Property (Wrap-around Services)
 - Head Start
 - Blue Ribbon Task Force
 - Multnomah Health Clinic
 - Clothing Shelter
 - Student/Parent Childcare Center
 - SUN Program
 - Portland Parks & Rec (PPR) Sports Facility needs?
 - Others

BUILDING ASSESSMENT

- Desirable Features – Interior
- Existing Programs/Space Allocations vs. EdSpec
- Location of Elements on Site – Adjacencies, parking, community access
- Heart of School – Media Center, Commons, Partner Services, Admin?
- Security – Card Reader Access, zoning buildings for community use, etc.
- Other

COMMUNICATION

Communication Tools

- Other Stakeholders
- Other Meeting locations
- Means of communication
- Frequencies
- Outreach
- Other

